

CORPORATE CAMPUS EAST

BUILDING 3025 / SUITE 105

±1,450 RSF | MARKET READY



FOR MORE INFO
PLEASE CONTACT

SCOTT DAVIS

EXECUTIVE VICE PRESIDENT

+1 425 941 7573

SCOTT.DAVIS@CBRE.COM

ROBERT BAKER

TRANSACTION SPECIALIST

+1 425 462 6974

ROBERT.BAKER@CBRE.COM

CBRE



Lake Washington
PARTNERS



VIRTUAL TOUR



VIEW CONCEPTUAL
FURNITURE PLAN

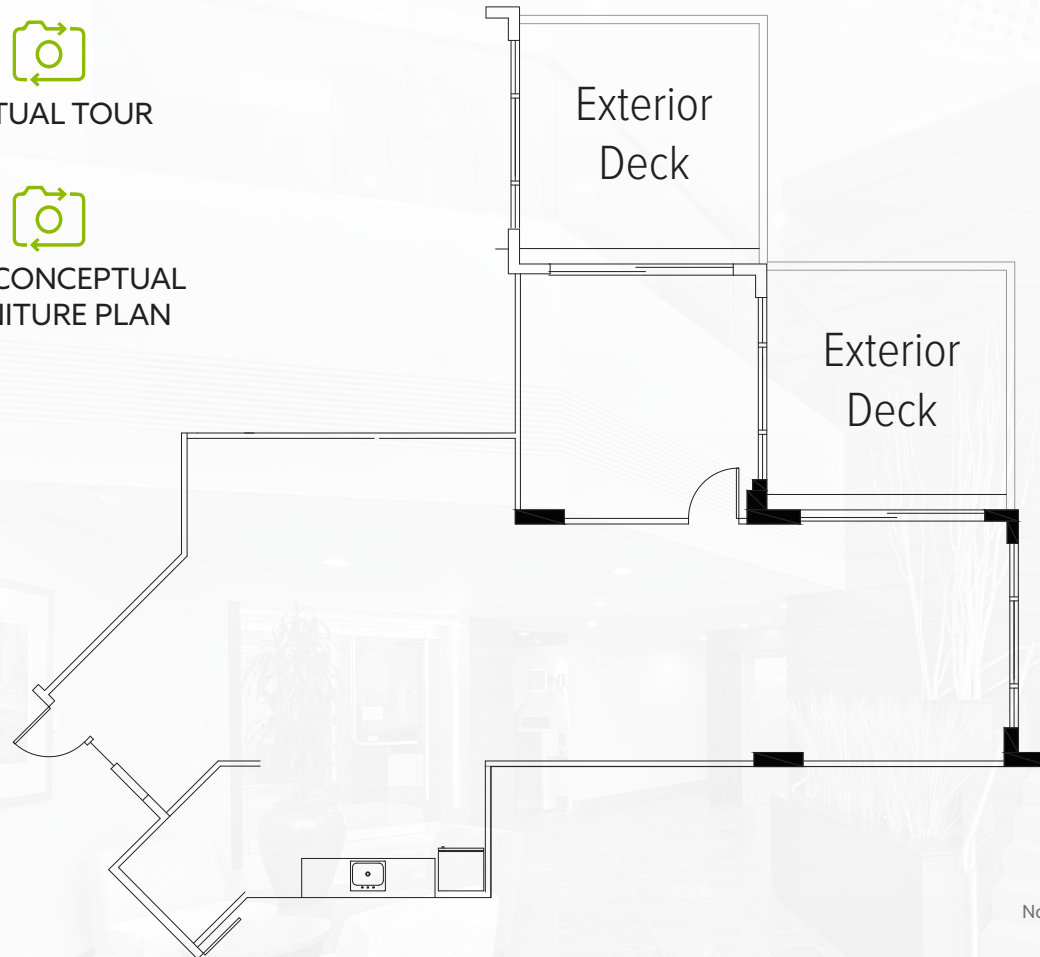

© 2025 CBRE, Inc. All rights reserved. This information has been obtained from sources believed reliable, but has not been verified for accuracy or completeness. You should conduct a careful, independent investigation of the property and verify all information. Any reliance on this information is solely at your own risk. CBRE and the CBRE logo are service marks of CBRE, Inc. All other marks displayed on this document are the property of their respective owners, and the use of such logos does not imply any affiliation with or endorsement of CBRE. Photos herein are the property of their respective owners. Use of these images without the express written consent of the owner is prohibited. RB 8.18.2025

CORPORATE CAMPUS EAST

BUILDING 3025 / SUITE 105

±1,450 RSF | CONCEPTUAL FURNITURE PLAN



FOR MORE INFO
PLEASE CONTACT

SCOTT DAVIS

EXECUTIVE VICE PRESIDENT

+1 425 941 7573

SCOTT.DAVIS@CBRE.COM

ROBERT BAKER

TRANSACTION SPECIALIST

+1 425 462 6974

ROBERT.BAKER@CBRE.COM

CBRE

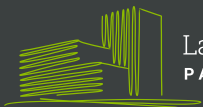

Lake Washington
PARTNERS



VIRTUAL TOUR



VIEW CONCEPTUAL
FURNITURE PLAN

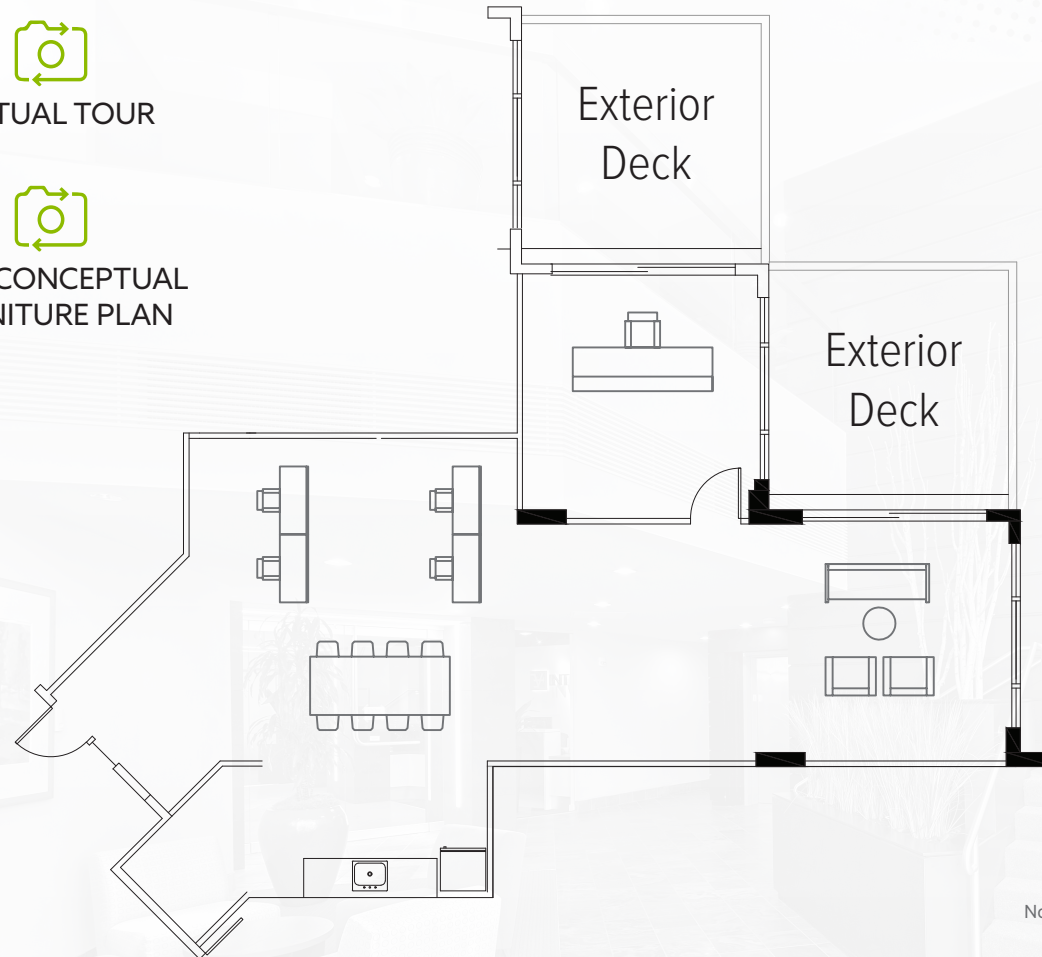

Not to Scale



© 2025 CBRE, Inc. All rights reserved. This information has been obtained from sources believed reliable, but has not been verified for accuracy or completeness. You should conduct a careful, independent investigation of the property and verify all information. Any reliance on this information is solely at your own risk. CBRE and the CBRE logo are service marks of CBRE, Inc. All other marks displayed on this document are the property of their respective owners, and the use of such logos does not imply any affiliation with or endorsement of CBRE. Photos herein are the property of their respective owners. Use of these images without the express written consent of the owner is prohibited. RB 8.18.2025