

CORPORATE CAMPUS EAST

BUILDING 3055 / SUITE 210

±1,716-5,305 SF | AVAILABLE FEB. 2024 OR SOONER



FOR MORE INFO
PLEASE CONTACT

SCOTT DAVIS

EXECUTIVE VICE PRESIDENT

+1 425 941 7573

SCOTT.DAVIS@CBRE.COM

ROBERT BAKER

TRANSACTION SPECIALIST

+1 425 462 6974

ROBERT.BAKER@CBRE.COM

CBRE



Lake Washington
PARTNERS

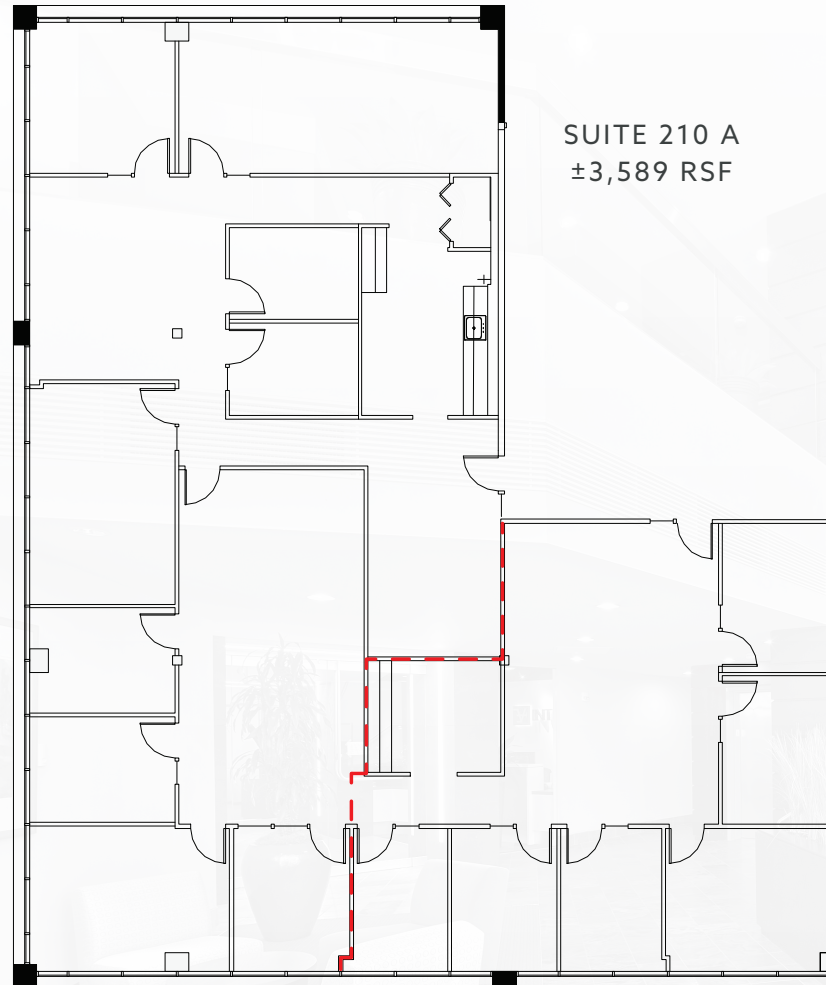

SUITE 210 A
±3,589 RSF

SUITE 210 B
±1,716 RSF



Not to Scale

© 2023 CBRE, Inc. All rights reserved. This information has been obtained from sources believed reliable, but has not been verified for accuracy or completeness. You should conduct a careful, independent investigation of the property and verify all information. Any reliance on this information is solely at your own risk. CBRE and the CBRE logo are service marks of CBRE, Inc. All other marks displayed on this document are the property of their respective owners, and the use of such logos does not imply any affiliation with or endorsement of CBRE. Photos herein are the property of their respective owners. Use of these images without the express written consent of the owner is prohibited. SE 11.9.2023

CORPORATE CAMPUS EAST

BUILDING 3055 / SUITE 210

CONCEPTUAL PLAN | AVAILABLE FEB. 2024 OR SOONER



FOR MORE INFO
PLEASE CONTACT

SCOTT DAVIS

EXECUTIVE VICE PRESIDENT

+1 425 941 7573

SCOTT.DAVIS@CBRE.COM

ROBERT BAKER

TRANSACTION SPECIALIST

+1 425 462 6974

ROBERT.BAKER@CBRE.COM

CBRE

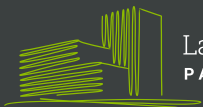

Lake Washington
PARTNERS

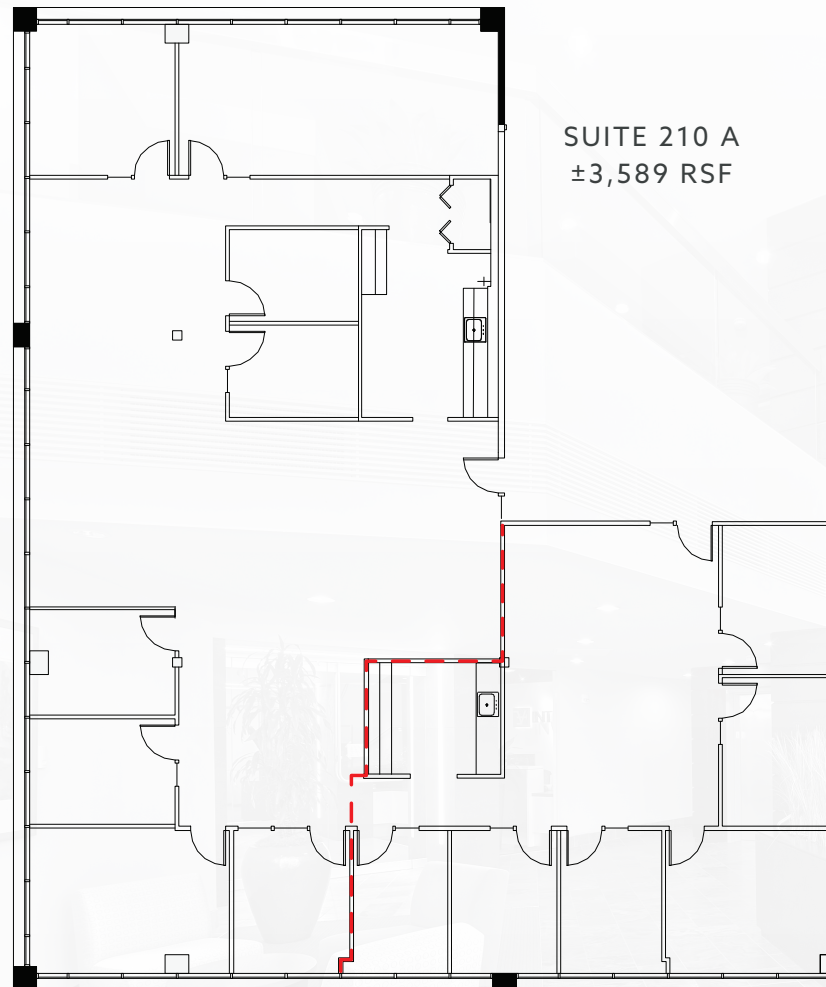

SUITE 210 A
±3,589 RSF

SUITE 210 B
±1,716 RSF



Not to Scale

© 2023 CBRE, Inc. All rights reserved. This information has been obtained from sources believed reliable, but has not been verified for accuracy or completeness. You should conduct a careful, independent investigation of the property and verify all information. Any reliance on this information is solely at your own risk. CBRE and the CBRE logo are service marks of CBRE, Inc. All other marks displayed on this document are the property of their respective owners, and the use of such logos does not imply any affiliation with or endorsement of CBRE. Photos herein are the property of their respective owners. Use of these images without the express written consent of the owner is prohibited. SE 11.9.2023